

HTB Standard Lugs

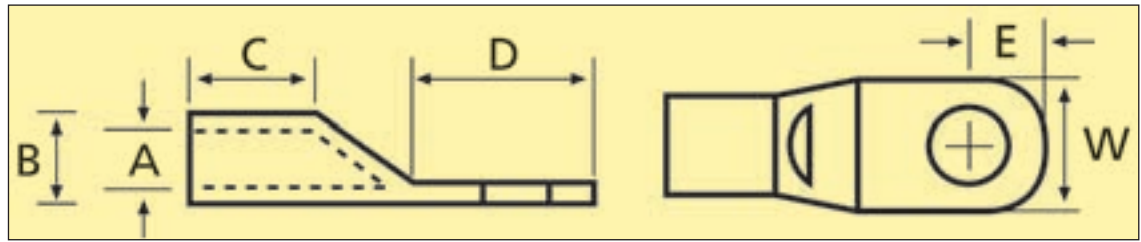

Technical Table

Cable Size (mm ²)	Stud (mm)	Code	Dimensions (mm)						
			Barrel				Spade		
			A ID	B OD	t Thickness	C Length	D Length	E Hole to End	W Width
1.5	3	HTB13	1.8	3.7	0.95	5	9	4	8
	4	HTB14	↓	↓	↓	↓	↓	↓	↓
	5	HTB15	↓	↓	↓	↓	↓	↓	↓
	6	HTB16	↓	↓	↓	↓	↓	↓	↓
2.5	3	HTB23	2.4	4.0	0.80	7	11	5	8
	4	HTB24	↓	↓	↓	↓	↓	↓	8
	5	HTB25	↓	↓	↓	↓	↓	↓	10
	6	HTB26	↓	↓	↓	↓	↓	↓	10
4	8	HTB28	↓	4.3	0.95	8	15	8	12
	3	HTB43	3.1	4.8	0.85	7	11	5	10
	4	HTB44	↓	↓	↓	↓	↓	↓	↓
	5	HTB45	↓	↓	↓	↓	↓	↓	↓
	6	HTB46	↓	↓	↓	↓	↓	↓	↓
6	8	HTB48	↓	4.9	0.90	8	17	7	13
	10	HTB410	↓	4.9	0.90	11	19	8	14
	4	HTB64	3.4	5.1	0.85	9	11	5	10
	5	HTB65	↓	↓	↓	↓	11	5	10
	6	HTB66	↓	↓	↓	↓	15	6	12
10	8	HTB68	↓	↓	↓	↓	15	6	12
	10	HTB610	↓	5.6	1.10	11	20	8	15
	5	HTB105	4.5	6.2	0.85	9	13	6	12
	6	HTB106	↓	↓	↓	↓	13	↓	↓
	8	HTB108	↓	↓	↓	↓	15	↓	↓
16	10	HTB1010	↓	6.6	1.05	11	19	8	15
	12	HTB1012	↓	6.6	1.05	12	20	10	19
	5	HTB165	5.5	7.2	0.85	12	14	7	12
	6	HTB166	↓	↓	↓	↓	↓	↓	↓
	8	HTB168	↓	↓	↓	↓	↓	↓	↓
	10	HTB1610	↓	7.6	1.05	↓	20	8	15
25	12	HTB1612	↓	↓	↓	↓	25	11	18
	16	HTB1616	↓	↓	↓	↓	27	13	24
	6	HTB256	6.9	8.9	1.00	12	14	7	13
	8	HTB258	↓	↓	↓	↓	14	7	16
	10	HTB2510	↓	↓	↓	↓	21	10	18
35	12	HTB2512	↓	9.4	1.25	15	21	11	18
	16	HTB2516	↓	9.4	1.25	15	27	13	24
	6	HTB356	8.2	10.6	1.20	12	18	9	15
	8	HTB358	↓	↓	↓	↓	18	9	15
	10	HTB3510	↓	↓	↓	↓	21	10	18
50	12	HTB3512	↓	↓	↓	↓	21	10	18
	16	HTB3516	↓	11.2	1.50	16	30	13	24
	6	HTB506	10.0	12.9	1.45	16	21	10	18
	8	HTB508	↓	↓	↓	↓	↓	↓	18
	10	HTB5010	↓	↓	↓	↓	↓	↓	20
	12	HTB5012	↓	↓	↓	↓	↓	↓	20
70	14	HTB5014	↓	↓	↓	↓	↓	13	26
	16	HTB5016	↓	↓	↓	↓	↓	↓	↓
	20	HTB5020	↓	↓	↓	↓	↓	↓	↓
	8	HTB708	11.7	15.2	1.75	18	25	12	21
	10	HTB7010	↓	↓	↓	↓	↓	↓	↓
70	12	HTB7012	↓	↓	↓	↓	↓	↓	↓
	16	HTB7016	↓	↓	↓	↓	32	14	28
	20	HTB7020	↓	↓	↓	↓	34	15	30